

江苏鑫紫鲸机械制造集团有限公司
地址：中国江苏省张家港市南丰镇兴园路 4 号厂房
电话：0512-58658676
传真：0512-58658676
网站：WWW.KIWL.MACHINE.COM
WWW.SEASONINGPACKAGINGMACHINERY.COM

KIWL 鑫紫鲸®

该画册上展示的设备和技术参数仅是参照客户的解决方案，仅作参考。我司保留随时修改的权利，且不另行通知！
The machines and equipment shown in this brochure as well as the technical parameters represent only examples of customer-specific technical solutions. We reserve the right to make changes at any time without notice!

Jiangsu Xinzijing Machinery Manufacturing Group Co., Ltd.

ADDRESS: Building 4, Xingyuan Road, Nanfeng Town, Zhangjiagang City, Jiangsu Province, China

CHINA TEL: +86-0512-58658676

FAX: +86-0512-58658676

WEBSITE: WWW.KIWL.MACHINE.COM
WWW.SEASONINGPACKAGINGMACHINERY.COM

液体灌装 | LIQUID FILLING





CONTENT

公司简介/COMPANY BRIEF

业务范围/APPLICATIONS

生产线展示/FILLING LINES

灌装设备/FILLING EQUIPMENTS

洗瓶机设备/BOTTLE WASH EQUIPMENTS

封盖设备/CAPPING EQUIPMENTS

贴标设备/LABELING EQUIPMENTS

其他/OTHERS

公司简介

江苏鑫紫鲸机械制造集团有限公司依托强大的技术和产业优势，缔造的成熟现代化管理系统，在智能化整体解决方案领域，成为专业的灌装线整体解决方案提供商。

公司致力于灌装生产线的研发、生产以及销售。主要产品有全自动灌装机、理盖机、旋盖机、套标贴标机、打码机等灌装线全系列设备。

产品服务领域涉及：液体、药品、保健品、食品、酒类、医疗设备、化妆品、食品包装、医疗包装等诸多行业。

公司产品遵照ISO9001:2000国际质量管理体系认证，汇聚专业技术人员，形成一支高素质、年轻化、极富团队创新精神的队伍。

伴随着祖国的经济强盛，面对包装行业的巨大机遇，置泉怀着做中国出色的包装解决方案的梦想，致力于为各行业客户提供有竞争力的整体解决方案和服务，为客户创造最大价值。

COMPANY BRIEF

KIWL focuses on complete filling line solution based on our industry and technology advantages.

Our main products involve fully-automatic filling machine, capping machine, labeling machine, coding machine and etc for complete filling line. Our products are widely used for liquid, powder, granule, medicines, food, alcohol, cosmetic and etc.

Our company quality management system is processed strictly according to ISO9001:2000. We gather professional technicians and build a professional-trained and creative team.

We aim at being the most professional manufacturer of filling line to provide the perfect complete filling line solution for your products and create maximum value for customers.

CUSTOMERS 客户案例

我们的产品远销韩国、巴基斯坦、泰国、日本、丹麦、俄罗斯、南非、尼日利亚、美国、澳大利亚、加拿大等多个国家和地区，客户数量达1000家。

Our products are exported to South Korea, Pakistan, Thailand, Japan, Denmark, Russia, South Africa, Nigeria, the United States, Australia, Canada and other countries and regions, and the number of customers reaches 1,000.



- 01 更丰富的经验与实力
Richer experience and strength
- 02 更强的工厂生产能力
Stronger factory production capacity
- 03 更优秀的设计研发能力
Better design and development capabilities
- 04 同质量价格更合理
With the quality of the price is more reasonable
- 05 更用心的出货售后服务
More intentions of the ship after-sales service

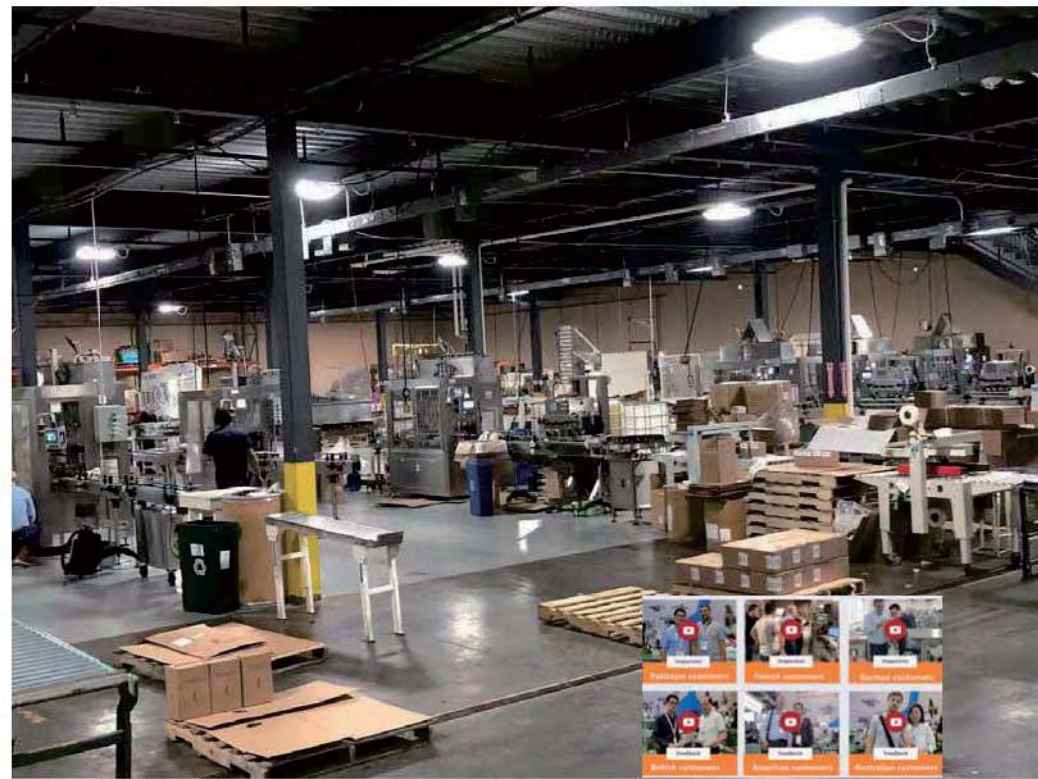

TEAM

团队管理

公司在不断发展过程中,建立完善的现代企业管理制度,内部各机构资源优化,合理配合,分工合作,协调统一,已形成一个高效运行的管理工作团队。完善的制度结构,高效、严谨的运行机制,是良好的管理决策和稳健的业务发展的坚实基础。

In the process of continuous development, the company has established a complete modern enterprise management system, optimized internal organization resources, reasonable cooperation, division of labor, coordination and unity, and has formed an efficient management team. A sound system structure, an efficient and rigorous operating mechanism are a solid foundation for good management decision-making and stable business development.



WORKSHOP

生产车间

市场竞争的基础,离不开生产实力,离不开完善先进的硬件设施。深知硬件设施重要性的振祥,在同行业内率先引进国外先进的生产设备,几年来更先后投资资金对硬件设施进行更新换代,以国际化的生产设施生产出符合国际标准的高端优质产品。

The basis of market competition is inseparable from production strength and complete and advanced hardware facilities. Knowing the importance of hardware facilities, Zhenxiang took the lead in introducing advanced foreign production equipment in the industry. Over the past few years, he has invested funds to upgrade the hardware facilities and produce high-end quality products that meet international standards with international production facilities.



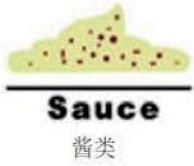



食用油灌装线参数 Edible Oil Filling line specification

- 灌装头数 Filling nozzles: 8
- 灌装速度 Filling Speed: about 2500 bottles/hour
- 灌装精度 Filling Accuracy: $\pm 1\%$
- 灌装形式 Filling Form: 伺服活塞灌装 servo piston filling
- 程序控制 Program Control: PLC&Touch Screen
- 物料接触部分 Material Contact Part: 304/316 不锈钢
- 气压 Air Pressure: 0.6-0.8MPa
- 料槽容量 Top Tank Capacity: "150L (不同的灌装量和灌装速度, 料槽容量不一定 depends on the machine size) "
- 保护装置 Protection Device: 缺料停机报警 filling material shortage shutdown and alarm

简介Introduction:

NPACK主要的食用油灌装机是直线(线性)活塞灌装机,具有2到16个灌装嘴可选以及旋转式高速灌装旋盖一体机,具有从12个喷嘴到36个喷嘴的灌装喷嘴。我们的向日葵食用油灌装机旨在满足向日葵油行业不断变化的需求。我们根据您的瓶子设计和容量,以及您的葵花油灌装需求制造机械,以满足您的生产目标。

NPACK edible oil filling machine are inline (linear) piston filling machine which has filling nozzles from 2 to 16 nozzles, rotary high speed filling machine monoblock one which has filling nozzles from 12 nozzles to 36 nozzles. Our sunflower edible oil liquid filling machines are designed to meet the changing needs of the sunflower oil industry. We manufacture the ideal machinery to handle your sunflower oil filling needs and meet your production goals. base on your bottle design and capacity.



12头伺服活塞灌装机参数 12 nozzles servo piston filling machine

- 灌装头数 Filling nozzles : 12
- 灌装范围 Volume Range: 1-5L
- 灌装速度 Filling Speed : about 4300 bottles/hour(for 1L liquid)
- 灌装精度 Filling Accuracy: $\pm 1\%$
- 灌装形式 Filling Form : 下潜灌装 (减少物料起泡) diving filling to prevent foaming
- 物料接触部分 Material Contact Part : 304/316 不锈钢
- 气压 Air Pressure : 0.6-0.8MPa
- 保护装置 Protection Device : 缺料停机报警 filling material shortage shutdown and alarm

6轮搓盖机 6 wheels spindle screw capping machine

- 旋盖速度 capping speed : "60-100 瓶 / 分 (具体速度由盖子和瓶子决定)"
- 60-100 bottles/min (actual speed depends on cap and bottle size)"
- 盖径 Cap Diameter : 20-120mm
- 瓶高 Bottle Height : 45-460mm
- 功率 Power : 1600W
- 气压 Air Pressure : 0.6-0.8MPa
- 选配 Option : 理盖机 Cap Sorter

Pharmaceutical Liquid Filling Line
制药生产线



全自动灌装加塞旋盖一体机 Automatic Filling Stoppering and Capping monoblock features

- 灌装头数 Filling heads : 2
- 灌装速度 Filling Speed : 25-30 瓶 / 分 (具体速度由灌装量和瓶子尺寸决定)
- 25-30 b/m (actual speed depends on filling volume and bottle size)
- 压内塞头数 Stoppering Head : 1
- 旋盖头数 : 1
- PLC& 触摸屏 PLC and touch screen : Germany Siemens brand
- 伺服电机 Servo motor : Panasonic
- *Material contact parts are 316SS, and machine construction material is 304SS
不锈钢物料接触部分, 304 不锈钢机器框架*

全自动圆瓶贴标机 Automatic Round Bottle Labeling Machine

- 贴标速度 Labeling speed : 40-100 (relate to material and label size)
- 贴标精度 Labeling accuracy : $\pm 1.0\text{mm}$ (material and label sizes are not counted in)
- 标签尺寸 Label size : (L)20-280mm (H)25-140mm
- 产品尺寸 Material size : $\Phi 20-\Phi 100\text{mm}$ (H)40-200mm
- 标签卷内径 Roll inside : $\Phi 76\text{mm}$
- 标签卷外径 Roll outer diameter : Max : $\Phi 350\text{mm}$
- 机器尺寸 Machine size : (L)2000*(W)850*(H)1450(mm)
- 电源 Power supply : AC220V 50Hz/60Hz 1500W



全自动灌装加塞旋盖一体机 Automatic Filling Stoppering and Capping monoblock features

- 灌装头数 Filling heads : 2
- 灌装速度 Filling Speed : 25-30 瓶 / 分 (具体速度由灌装量和瓶子尺寸决定)
25-30 b/m(actual speed depends on filling volume and bottle size)
- 压内塞头数 Stoppering Head : 1
- 旋盖头数 : 1
- PLC& 触摸屏 PLC and touch screen : Germany Siemens brand
- 伺服电机 Servo motor : Panasonic
- 不锈钢物料接触部分, 304 不锈钢机器框架
Material contact parts are 316SS, and machine construction material is 304SS

全自动圆瓶贴标机 Automatic Round Bottle Labeling Machine

- 贴标速度 Labeling speed : 40-100 (relate to material and label size)
- 贴标精度 Labeling accuracy : $\pm 1.0\text{mm}$ (material and label sizes are not counted in)
- 标签尺寸 Label size : (L)20-280mm (H)25-140mm
- 产品尺寸 Material size : $\Phi 20-\Phi 100\text{mm}$ (H)40-200mm
- 标签卷内径 Roll inside : $\Phi 76\text{mm}$
- 标签卷外径 Roll outer diameter: Max : $\Phi 350\text{mm}$
- 机器尺寸 Machine size : (L)2000*(W)850*(H)1450(mm)
- 电源 Power supply : AC220V 50Hz/60Hz 1500W



12 头伺服活塞灌装机参数 12 nozzles servo piston filling machine

- 灌装头数 Filling nozzles : 12
- 灌装范围 Volume Range: 1-5L
- 灌装速度 Filling Speed : about 4300 bottles/hour(for 1L liquid)
- 灌装精度 Filling Accuracy: $\pm 1\%$
- 灌装形式 Filling Form : 下潜灌装 (减少物料起泡) diving filling to prevent foaming
- 物料接触部分 Material Contact Part : 304/316 不锈钢
- 气压 Air Pressure : 0.6-0.8MPa
- 保护装置 Protection Device : 缺料停机报警 filling material shortage shutdown and alarm

6 轮搓盖机 6 wheels spindle screw capping machine

- 旋盖速度 capping speed : 60-100 瓶 / 分 (具体速度由盖子和瓶子决定)
60-100 b/m (actual speed depends on cap and bottle size)
- 盖径 Cap Diameter : 20-120mm
- 瓶高 Bottle Height : 45-460mm
- 功率 Power : 1600W
- 气压 Air Pressure : 0.6-0.8MPa
- 选配 Option : 理盖机 Cap Sorter

Horizontal Piston Filling Machine 经济灌装机



特点 FEATURES

主机材料采用304不锈钢构成。可选物料接触部分为316不锈钢。

设备符合GMP标准，所有物料接触部分均可选配食品级材料。

适用于不同瓶型、不同容量的灌装。

驱动：驱动部分采用伺服电机驱动，灌装过程稳定可靠，灌装速度、灌装量、灌装精度均在触摸屏上可调，使用方便。

采用施耐德触摸屏作为人机界面，操作简单方便，稳定可靠。

采用防滴漏灌装头，防止灌装后滴漏。

采用下潜式灌装头设计，针对起泡型液体物料设计。

可选配防滴漏接漏槽，进一步确保无物料滴漏至瓶身、输送带和其他区域。

配备自动补液系统的料斗，当液位过低时，自动开启补液，确保物料足够供应和生产的流畅性。可选带有加热或者保温功能的料斗。

灌装范围：1-5L

灌装精度：< ±0.1%

Controlled by servo system. Adjustable filling speed

Accurate to ±0.1%

Integrated digital control with Schneider PLC and high tech touch screen controls for easy operation.

Designed for easy changeover and cleaning.

Professional manufacturing techniques using the ISO-9001 system.

304 or 316L stainless steel.

Bottom-up filling for option.

Bottle neck location.

No bottle-no fill system.

Filling zone protected by stainless steel frame

Volume is easily adjusted through touch screen. Filling pistons are controlled by servo system.

Individual piston adjustment.

Digital control system to enable multiple filling actions on the same bottle for double, triple and more.

选型 SOLUTIONS

型号/ITEM NO.	RJ-EVF2	RJ-EVF4
灌装头数/Filling Heads	2	4
灌装范围/Filling Range	100-500ml, 100-1000ML 1000-5000ML	
产量/Capacity	6-14bpm(瓶/分钟)	12-28bpm(瓶/分钟)
气源气压/Air Pressure	0.6MPA	
电源/Power	2000W 220VAC 1P	

Severo Piston Filling Machine
伺服灌装机



特点 FEATURES

主机材料采用304不锈钢构成。可选物料接触部分为316不锈钢。

设备符合GMP标准，所有物料接触部分均可选配食品级材料。

适用于不同瓶型、不同容量的灌装。

驱动：驱动部分采用伺服电机驱动，灌装过程稳定可靠，灌装速度、灌装量、灌装精度均在触摸屏上可调，使用方便。

采用施耐德触摸屏作为人机界面，操作简单方便，稳定可靠。

采用防滴漏灌装头，防止灌装后滴漏。

采用下潜式灌装头设计，针对起泡型液体物料设计。

可选配防滴漏接漏槽，进一步确保无物料滴漏至瓶身、输送带和其他区域。

配备自动补液系统的料斗，当液位过低时，自动开启补液，确保物料足够供应和生产的流畅性。可选带有加热或者保温功能的料斗。

灌装范围：1-5L

灌装精度：< ±0.1%

Controlled by servo system. Adjustable filling speed

Accurate to ±0.1%

Integrated digital control with Schneider PLC and high tech touch screen controls for easy operation.

Designed for easy changeover and cleaning.

Professional manufacturing techniques using the ISO-9001 system.

304 or 316L stainless steel.

Bottom-up filling for option.

Bottle neck location.

No bottle-no fill system.

Filling zone protected by stainless steel frame

Volume is easily adjusted through touch screen.

Filling pistons are controlled by servo system.

Individual piston adjustment.

Digital control system to enable multiple filling actions on the same bottle for double, triple and more.



选型 SOLUTIONS

型号/ITEM NO.	RJ-EVF2	RJ-EVF4
灌装头数/Filling Heads	2	2
灌装范围/Filling Range	100-500ml, 100-1000ML	1000-5000ML
产量/Capacity	6-14bpm(瓶/分钟)	12-28bpm(瓶/分钟)
气源气压/Air Pressure	0.6MPA	
电源/Power	2000W 220VAC 1P	

Tracking Type Filling Machine
跟踪灌装机



特点 FEATURES

跟踪式高速双头灌装机由链式输送机、夹瓶自动对中机构、灌装机构、自动伺服活塞系统、电动升降调节机构、防水电气柜、触摸式人机操作界面等组成。

本机具有一键式快速切换功能，适用于不同规格瓶子的自动灌装设备。

可选择下潜式灌装头设计，针对起泡型液体物料设计

驱动：驱动部分采用伺服电机驱动，灌装过程稳定可靠。

灌装速度、灌装量、灌装精度均在触摸屏上可调，使用方便

Tracking type high-speed double heads filling machine consists of chain conveyor, bottle clamping automatic alignment mechanism, filling mechanism, automatic servo piston system, electric lifting adjustment mechanism, waterproof electric cabinet, touch man-machine operation interface, etc.

This machine has the function of a one-button quick changeover, which can be applied to the automatic filling equipment for bottles of different specifications.

Bottom Up filling system for optional, designed for easy foamy liquid.

Drive: the drive part is driven by servo motor; the filling process is stable and reliable, and the filling speed, filling volume and filling accuracy are adjustable on the touch screen, which is convenient to use

参数 PARAMETERS

1 灌装精度 Filling Accuracy	±1%
2 灌装头 Filling nozzles	2 heads
3 灌装方式 Filling form	伺服活塞灌装 Servo piston type
4 控制程序 Program control	PLC+触摸屏 PLC+touch screen
5 空气压力 Air pressure	0.6-0.8Mpa
6 灌装速度 Filling speed	About 40-50 bottles/min
7 服务Service	网上在线指导, 视频技术指导 Online support, Video technical support
8 灌装物料 Filling Material	Water, Oil, Juice, Shampoo, Lotion, Detergent and Other 水, 油, 果汁, 洗发水, 沐浴乳, 洗涤剂和其他

Filling and Capping Machine
灌装旋盖一体机



特点 FEATURES

本机集灌装，加内塞，上盖，旋盖功能于一体。
高精度伺服活塞泵灌装，计量准确，可调，维修方便，操作方便。
具有无瓶不灌装，无瓶不加塞，无内塞不旋盖的功能
主机材料采用304不锈钢构成。可选物料接触部分为316不锈钢。
设备符合GMP标准，所有物料接触部分均可选配食品级材料。
带紧急停机开关，机器故障时自动报警。
灌装精度：$\pm 0.1\%$

The machine integrates the functions of filling, plug inserting, cap loading and capping.
High precision servo piston pump filling, measuring accurate, adjustable, convenient maintenance, easy operation,
No bottle no filling, no bottle no plug, not plug cover function.
The machine fram is made of 304 stainless steel. The 316 stainless steel material contact part is optional.
The equipment complies with GMP standards, and all material contact parts can be equipped with food grade materials.
With urgent stop switch, automatic alarm when machine is out of order.

参数 Parameters

1 灌装头数 Filling heads	2
2 灌装速度 Filling Speed	25-30 瓶/分(具体速度由灌装量和瓶子尺寸决定 25-30 bottles/min (actual speed depends on filling volume and bottle size)
3 压内塞头数 Stopperng Head	1
4 旋盖头数	1
5 PLC&触摸屏 PLC&Touch Screen	德国西门子 Siemens
6 伺服电机 Servo Motor	日本松下 Panasonic

Auto Weigh Filling Machine
称重灌装机



特点 FEATURES

主机材料采用304不锈钢构成。可选物料接触部分为316不锈钢。

设备符合GMP标准，所有物料接触部分均可选配食品级材料。

适用于不同瓶型、不同容量的灌装。

驱动：驱动部分采用伺服电机驱动，灌装过程稳定可靠，灌装速度、灌装量、灌装精度均在触摸屏上可调，使用方便。

采用施耐德触摸屏作为人机界面，操作简单方便，稳定可靠。

采用防滴漏灌装头，防止灌装后滴漏。

采用下潜式灌装头设计，针对起泡型液体物料设计。

可选配防滴漏接漏槽，进一步确保无物料滴漏至瓶身、输送带和其他区域。

配备自动补液系统的料斗，当液位过低时，自动开启补液，确保物料足够供应和生产的流畅性。可选带有加热或者保温功能的料斗。

灌装范围：1-5L

灌装精度：< ±0.1%

Controlled by servo system. Adjustable filling speed

Accurate to ±0.1%

Integrated digital control with Schneider PLC and high tech touch screen controls for easy operation.

Designed for easy changeover and cleaning.

Professional manufacturing techniques using the ISO-9001 system.

304 or 316L stainless steel.

Bottom-up filling for option.

Bottle neck location.

No bottle-no fill system.

Filling zone protected by stainless steel frame

Volume is easily adjusted through touch screen. Filling pistons are controlled by servo system.

Individual piston adjustment.

Digital control system to enable multiple filling actions on the same bottle for double, triple and more.

选型 SOLUTIONS

型号/Item No.	NP-SWF300EX
产品/Product	防爆型半自动称重灌装机
最大秤量/Max Weight:	300kg
最小感量/Min. Weight:	100g
灌装误差/Accuracy:	±0.1%视灌装速度/Depending on Speed
灌装速度/Speed:	45-60桶/小时(视进料流速/Depending on flow speed)
适用容器/Container:	≤Φ600xh1000mm
防爆等级/EX:	EXdiaII BT4
使用电源/Power:	AC220/50Hz
使用气源/Air Pressure:	0.4-0.8Mpa
结构材质/Structure:	SUS304SS
枪头管路/Contact Parts:	SUS304SS/TEFLON/SUS316L
气源接口/Air Hose:	8mm



Auto Weigh Filling Machine
称重灌装机



型号/Item No.	NP-SWF30EX
产品/Product	防爆型半自动称重灌装机
最大秤量/Max Weight:	30kg
最小感量Min. Weight:	10g
灌装误差Accuracy:	±10-20g(视灌装速度/Depending on Speed)
灌装速度/Speed:	100-150桶/小时(视进料流速/Depending on flow speed)
适用容器/Container:	≤Φ350xh500mm
防爆等级/EX:	EXdiaIIBT4
使用电源/Power:	AC220/50Hz
使用气源/Air Pressure:	0.4-0.8Mpa
结构材质/Structure:	SUS304SS
枪头管路/Contact Parts:	SUS304SS/TEFLON/SUS316L
气源接口/Air Hose:	8mm



型号/Item No.	NP-SWF300EX
产品/Product	防爆型半自动称重灌装机
最大秤量/Max Weight:	300kg
最小感量Min. Weight:	100g
灌装误差Accuracy:	±0.1%视灌装速度/Depending on Speed)
灌装速度/Speed:	45-60桶/小时(视进料流速/Depending on flow speed)
适用容器/Container:	≤Φ600xh1000mm
防爆等级/EX:	EXdiaIIBT4
使用电源/Power:	AC220/50Hz
使用气源/Air Pressure:	0.4-0.8Mpa
结构材质/Structure:	SUS304SS
枪头管路/Contact Parts:	SUS304SS/TEFLON/SUS316L
气源接口/Air Hose:	8mm

Bottle Washing Machine
洗瓶机



特点 FEATURES

本机适用于圆瓶或方瓶容器的清洗、水洗涂和空气洗涂两种机型

整机采用SUS304不锈钢、铝合金和工程塑料制造。

控制系统采用进口PLC可编程控制器，具有大型LCD人机界面。

提供20组存储区，可存储清洗时间和参数。

瓶子自动翻转装置由夹瓶组和旋转电机组成，可将瓶子旋转180度。

This machine is suitable for round bottle or square bottle container cleaning, washing and air washing two models

The whole machine is made of SUS304 stainless steel, aluminum alloy and engineering plastics.

The control system adopts imported PLC programmable controller, with large LCD man-machine interface.

Provide 20 groups of memory area, can store the cleaning time and parameters.

The container automatic turnover device is composed of bottle clamping group and rotary motor, which can rotate the container 180

degrees.



选型 SOLUTIONS

1 可用瓶子Kind of bottle*	圆形 方形 玻璃塑料瓶Round or flat hard plastic/glass bottle stand stably on conveyor
2 瓶子尺寸Bottle size*	最小直径: 40mm 最大直径 80mmMin. Ø 40mm Max. Ø80mm customized
3 洗瓶头数Rinser nozzles	2-16heads
4 速度Speed	10-80 b/m
5 电源 Power*	220V 50/60Hz 0.45kw
6 机器尺寸Machine size	长Length 1400, 宽width 1000,高 height 1600
7 机器重量Machine weight:	500kgs

搓盖机类

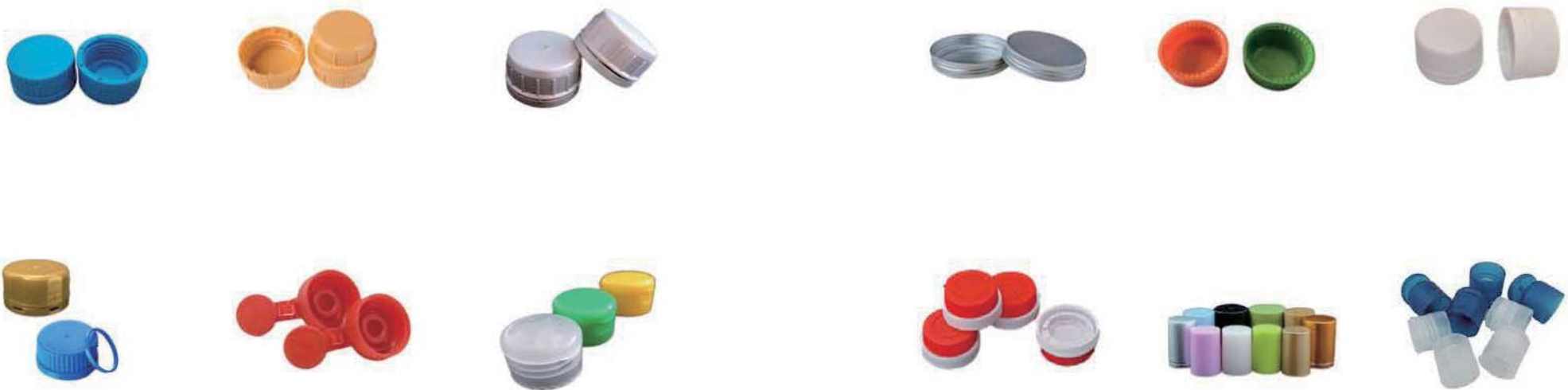

Spindle Screw Capping Machine
六轮旋盖机



特点 FEATURES

由3组6个搓盖轮进行紧盖。
第一组轮子可设置反转，专为马口铁盖设计。
每一个轮子由独立的电机控制。
每一组轮子由独立的DANFOSS变频器控制。
夹瓶皮带由两个电机驱动，由一个DANFOSS变频器控制。
适用于各种旋入式盖型，不同尺寸均可适用。
产量：60-100瓶/分钟。
触摸屏控制。
每一组轮子和皮带配备有计数器。
夹瓶皮带上下调节配备有刻度标尺。
主机升降采用电机驱动，操作简单方便

Power height adjustment
Comprehensive universal cap chute and escapement
Hand-wheel operated
Gripper Belt height and width adjustment
Variable speed AC motors 4, 6 or 8
Spindle Wheels Spindle Wheel adjustment knobs, with lock nut hand wheel
No change parts required for a wide range of containers
Sanitary 304 stainless steel drive shafts and adjustment support shafts
Timing belt power transmission for Spindle Wheels
Bottom screw changeover on Spindle Wheels
1/2" aluminum mounting plates and 1/2" hard coat anodized supports on Cap Feed Chute
Designed for easy integration with most conveyor configurations (sold separately)
Intrinsically Safe
Removable dual gripper belts
Trigger spray cap rails

参数 PARAMETERS



设备名称/Product	搓盖机/Spindle Capper	电压/Voltage	220VAC 1P
型号/Item No.	RJ-LC	功率/Power	1600W
盖径/Cap Diameter	20-120MM	气压/Air Pressure	0.6MPA
瓶高/Bottle Height	45-460MM	重量/Weight	500KG
尺寸/Dimensions	1080*900*1700	选配/Option	理盖机/Cap Sorter

Servo Control Capping Machine
伺服4轮旋盖机



特点 FEATURES

由4个轮子双电机旋盖。

每一组轮子由独立伺服电机控制，扭力可调

通过变频器调节旋盖速度

可加装夹瓶装置进瓶提高产量
可选配伺服电机旋盖，扭力可以在触摸屏上设置

压盖装置采用可自由旋转设置，旋盖质量更高

触摸屏设置旋盖时间
使用不同尺寸的瓶子和盖子

4 spindle wheels for capping

Each wheel set is controlled by one servo motor, screw torque is adjustable

Applied for different sizes of caps and bottles Applied for trigger caps

Height is adjustable manually, adjustment with motor for option

Servo motor with torque setting on touch screen for option

Capping torque and capping time is adjustable



参数 SPECIFICATIONS

设备名称/Product	旋盖机/Screw Capper	电压/Voltage	220VAC 1P
型号/Item No.	NP-SC4	功率/Power	500W
盖径/Cap Diameter	20-80MM	气压/Air Pressure	0.6MPA
瓶高/Bottle Height	45-460MM	重量/Weight	200KG
尺寸/Dimensions	760*760*1700	选配/Option	理盖机/Cap Sorter

Auto Vacuum Capping Machine
真空旋盖机



特点 FEATURES

本机是我公司多年经验研制开发，具有国内独一无二的特点，集上盖，真空封盖于一体。采用手动真空泵达到高真空。具有无盖报警功能且高度自动化。主要气动和电气部件来自世界知名品牌。性能稳定可靠，广泛用于罐装食品，饮料，调味品，保健品等行业的带有铁质盖子的玻璃罐真空封盖。

主要特点

- 1) 集自动封盖和真空封盖于一体，自动化程度高。
- 2) 采用手动真空泵达到高真空。
- 3) 扭力和真空度可根据需要设定。
- 4) 适用于不同形状和尺寸的瓶子。
- 5) 主要气动和电气部件均来自世界知名品牌，性能稳定可靠耐用。

This machine is researched and developed by our company with years of experience, it is unique in domestic. Integrated automatically cap arranging with covering, vacuum capping. Adopted manual vacuum pump to achieve high vacuum. With the functions of no bottle no covering, alarming when no caps are available. Enjoyed high automation. The main pneumatic and electric parts are from world famous brands. With stable and reliable performance. It is widely used for vacuum capping of the Glass Jars with iron caps in the industries of canned food, beverage, seasoning, health care products etc.

Integrated automatically cap arranging with covering and vacuum capping, with high automation.

Adopted manual vacuum pump to achieve high vacuum.

Capping torsion and vacuum degree can be set as required. Suitable for different shapes and sizes bottles with changing few parts.

The main pneumatic and electric parts are from world famous brands to ensure stable, reliable and durable performance.



参数 SPECIFICATIONS

功率/POWER	≤2.3KW (含真空泵/INCLUDING VACUUM PUMP)
产能/CAPACITY	2200-2500 BPH
瓶盖直径/LID DIAMETER	φ30-φ55mm φ50-φ85mm
瓶子高度/BOTTLE HEIGHT	80-250mm
瓶子直径/BOTTLE DIAMETER	φ30-485mm
最大真空度/MAX. VACUUM:	-0.08mpa
旋盖扭力/TORQUE:	5-20N.M
耗气量/AIR CONSUMPTION:	0.6M3 / 0.7Mpa
设备尺寸/SIZE	2100×900×1630mm 750X1060X1400mm
重量/WEIGHT	850kg

Cap Pressing Machine
压盖机



特点 FEATURES

采用链板式压盖，针对不同盖型可选配皮带压盖

压盖链板由变频器控制，速度调节更为简单精准，使得压盖质量更高

装配夹瓶装置，确保精准上盖的同时防止倒瓶

夹瓶装置采用变频器控制，通过调节适用不同尺寸的瓶子和盖子

压盖链板采用横轴式固定，结构稳定可靠。

Equipped with pressing chain or belt depending on cap types

Presser speed is controlled by converter, speed can be precisely adjustable. Ensure high capping quality

Bottle Clamping belt equipped to ensure high quality cap loading and prevent bottle from falling down

Applied for different sizes of caps and bottles

Strong structure designed, more reliable.



参数 SPECIFICATIONS

设备名称/Product	压盖机/Pressing Capper	电压/Voltage	220VAC 1P
型号/Item No.	NP-PC100	功率/Power	800W
盖径/Cap Diameter	20-80MM	气压/Air Pressure	0.6MPA
瓶高/Bottle Height	45-460MM	重量/Weight	200KG
尺寸/Dimensions	1760*850*1700	选配/Option	理盖机/Cap Sorter

ROPP Aluminum Capping Machine

铝盖 轧盖机



特点 FEATURES

自动旋盖机用于封闭各种类型的容器（由塑料，玻璃和金属制成）和铝盖。该机器尤其适用于食品加工，化妆品和化学工业。

机器可根据瓶盖的类型和尺寸配备不同类型的瓶盖理瓶器（振动式，旋转式，皮带式）。为了将瓶盖送入瓶盖理瓶器，可以使用瓶盖漏斗

为了将金属瓶盖放在容器颈上部，可以使用“拾放”系统

Automatic rotary capping machine is designed for closing various types of containers (made of plastic, glass and metal) with aluminum caps. The machine is especially suitable for use in the food-processing, cosmetic and chemical industries

The machine can be equipped with different types of cap unscrambler (vibrating, rotary, belt type) depending on the type and size of the cap. For feeding the caps into the cap unscrambler the caps hopper is available.

For placing difficult caps onto the container neck the "Pick and Place" system can be used



参数 SPECIFICATIONS

Model型号	NP-RC1	NP-RC2
Capacity产能	1800 -2000b/h	3000-4000 b/h
Suitable cap适用盖子	Aluminum caps/plastic screw caps铝盖/塑料螺	
Yield of cap上盖率	99%	
Dimension尺寸	2000x1000x1500mm	2200x1000x1500mm
Capping head旋盖头	1	2
Press head压盖头	1	2
Power consumption功耗	0.8KW	1.2KW
Weight(kg)重量	600kgs	700kgs

贴标机类

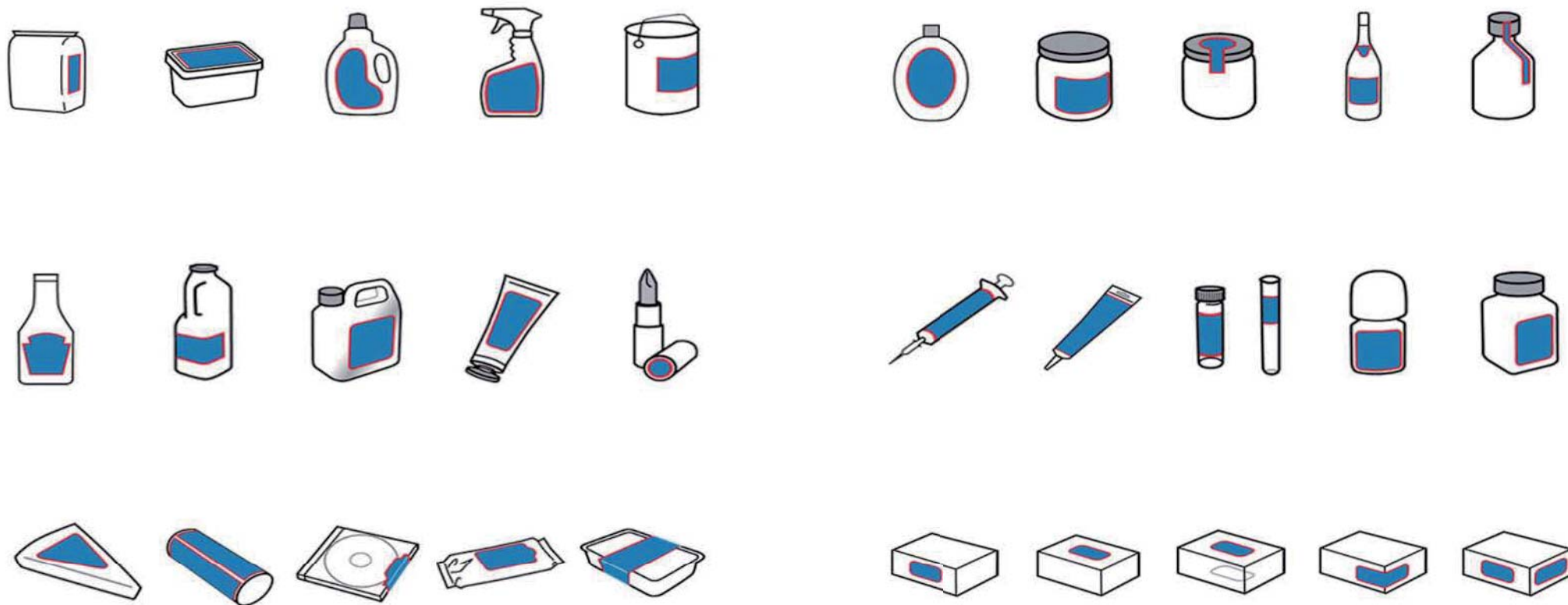

Double Sides Labeling Machine
双面贴标机



特点 FEATURES

功能强大，一台机可实现4种产品的单面和双面贴标（圆瓶、扁瓶、方瓶、异形瓶）

贴标系统、西门子PLC及功能模块、进口伺服电机出标稳定性及同步性极高，反应速度最快达300次/分，且扭力强，永不失步

采用了双侧刚性塑胶同步导向链条，自动保证瓶子对中性，对工人放瓶和流水线对接进瓶要求低，大大降低工人作业或流水线对接难度，可单机生产，也可接流水线生产

配置弹压式压顶机构，保证产品输送平稳，且有效消除瓶高的本身误差

配置自动分瓶机构，导瓶前自动分开间距，保证后续导瓶、输送和贴标的稳定性

配置两重覆标机构，首次保证贴标精度，二次挤压式覆标，有效消除气泡和保证标签头尾处贴紧

智能控制，自动光电追踪，具备无物不贴标，无标自动校正和标签自动检测功能，避免浪费标签和漏贴
设备主要材料采用不锈钢和高级铝合金，符合GMP生产规范，整体结构牢固，美观大方

Wide Application, one machine can realize single-sided and double-sided labeling of four types of products (round bottle, flat bottle, square bottle and special-shaped bottle)

PLC CONTROL, Automatically check the length of labels

Equipped with warning device of insufficient labels, broken labels

No bottle, no labeling

No labels, no labeling

Servo motor control, stable labeling

The label head is adjustable for different size of bottles

It fits for different sizes of labels

The height of label height is adjustable to fits different label position on the bottle

The angle of label head is adjustable



参数 SPECIFICATIONS

型号/Item No.	NP-TS
产量/Capacity	30-100瓶/分 BPM (速度可调, 视物件大小及标签长度而定/Depending on bottle sizes and label size)
精度/Accuracy	±1mm
瓶子直径/Bottle Diameter	Φ25-120mm 或定制 Or Customized
瓶高/Bottle Height	高度25mm ~ ~ 300mm (可根据客户要求定做) Or Customized
标签规格/Label Size	高度10mm ~ ~ 150mm 长度 15 ~ ~ 300mm (特殊规格可定做) Or Customized
纸卷内径/Label Roll	I.D. Φ76mm O.D.: Φ320 (Max.)
重量/Weight	500KG
电源/POWER	1500W 220VAC 1P

Auto Round Bottle Labeling Machine
自动圆瓶贴标机



特点 FEATURES

1. 触摸屏和PLC控制。
 2. 大约30个记忆配方，便于不同尺寸瓶子贴标
 3. 标签缺失检测报警
 4. 同步速度可调
 5. 伺服电机驱动，实现高精度和高速
 6. 没有瓶子不贴标
1. Touch screen and PLC control
 2. Around 30 memory recipes for labeling parameters, easy for change bottle size.
 3. Low or missing label detect.
 4. Synchronized speed selection
 5. Servo motor drive for high accuracy and high speed
 6. No bottle no labeling

参数 SPECIFICATIONS



1 贴标速度 Labeling speed	40-100 (relate to material and label size)
2 贴标精度 Labeling accuracy	±1.0mm (material and label sizes are not counted in)
3 标签尺寸 Label size	(L)20-280mm (H)25-140mm
4 机器尺寸 Material size	Φ20-φ100mm (H)40-200mm
5 标签卷内直径 Roll inside	φ76mm
6 标签卷外直径 Roll outer diameter	Max: Φ350mm
7 机器尺寸 Machine size	(L)2000*(W)850*(H)1450(mm)
8 电源 Power supply	AC220V 50Hz/60Hz 1500W

Flat Surface Labeling Machine
平面贴标机

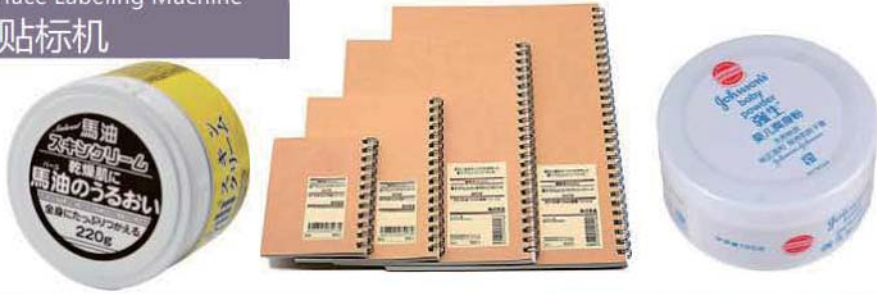

特点 FEATURES

适用范围广，可满足圆瓶、方瓶、扁瓶的盖子以及其它负载无的顶面贴标，瓶子间贴标切换简单，调整方便；

贴标精度高，细步步进电机或伺服电机驱动送标，送标精准；标带绕行纠偏机构设计，保证标签牵引过程中不左右偏移；偏心轮技术应用于牵引机构，牵引标签不打滑，确保出标精准；

坚固耐用，采用三杆调整机构，充分利用三角形的稳定性，整机结实耐用；

稳定性高，西门子PLC、西门子触摸屏、松下伺服电机组成的高级电控系统，支持设备7×24小时运转；

应用灵活，可单机生产或接流水线生产，生产现场布局简单；

智能控制，自动光电追踪，具备无物不贴标，无标自动校正和标签自动检测功能，防止漏贴和标签浪费；

触摸屏操作界面，全中文注释和完善的故障提示功能，各种参数调整简单快捷，操作方便；

功能强大，具有生产计数功能，省电功能，生产数设定提示功能，参数设置保护功能，方便生产管理

PLC CONTROL, Automatically check the length of labels

Equipped with warning device of insufficient labels, broken labels

No bottle, no labeling

No labels, no labeling

Servo motor control, stable labeling

The label head is adjustable for different size of bottles

It fits for different sizes of labels

The height of label height is adjustable to fits different label position on the bottle

The angle of label head is adjustable

参数 SPECIFICATIONS

型号/Item No.	NP-SL
产量/Capacity	120-250瓶/分 BPM (速度可调, 视物件大小及标签长度而定/Depending on bottle sizes and label size)
精度/Accuracy	±1mm
瓶子直径/Bottle Diameter	Φ25-120mm 或定制 Or Customized
瓶高/Bottle Height	高度25mm ~ ~ 300mm (可根据客户要求定做) Or Customized
标签规格/Label Size	高度10mm ~ ~ 150mm 长度 15 ~ ~ 300mm (特殊规格可定做) Or Customized
纸卷内径/Label Roll	I.D. Φ76mm O.D.: Φ320 (Max.)
重量/Weight	200KG
电源/POWER	550W 220VAC 1P

Hot Melt Glue Labeling Machine 热熔胶设备



特点 FEATURES

NP-HML热熔胶贴标机主要应用于饮料，食品，调味品行业，化妆品等行业也广泛使用。基于第一代机器改进，提高了性能稳定性，降低了综合用电量，提高了易损件使用寿命等。

瓶子贴标位置直径小于70MM，符合圆瓶贴标要求，适用于空瓶和灌瓶后贴标。

稳定的生产速度可达每分钟200瓶/每小时12,000瓶。

适用于客户只有圆形瓶型，产量高，生产力强的公司。。

NP-HML Hot Melt Adhesive Labeling Machines are mainly used in the beverage industry, food, condiment, cosmetic and other industries are also widely used.

is based on the first generation of models facelifted, increased performance stability, reduce overall electricity consumption, improve service life of wearing parts, and etc.

Bottle labeling location diameter not greater than 70MM's production line to meet a round bottle labelling requirements, applicable to the labeling for empty bottle and after filling bottle.

Stable production speed of up to 200 bottles per minute; 12,000 bottles per hour. Applicable to customers: only a circular bottle-type, production volume, high strength production company takes a long time.



参数 SPECIFICATIONS

输入功率Input Power : 1.5KW.

输入电压Input Voltage : ϕ 3,380/220VAC.

生产效率Production Efficiency : 100-150瓶/分(bottles/min).

主机尺寸Size of Host Machine : 2100L×850W×2000H.

适用瓶身直径Applicable Diameter of Bottle : 35mm~95mm.

适用标签长度Applicable Length of Label : 30mm~250mm.

适用标签厚度Applicable Thickness of Label : 0.03mm~0.13mm.

适用纸管内径Applicable Internal Diameter of Paper Tube : 5"~10"自由调整 Adjustable

选配 Option : 蒸汽收缩炉/电热收缩炉 Steam Tunnel/Electric Tunnel



Shrink Sleeving Labeling Machine 自动套标机



特点 FEATURES

全罩式不锈钢主机，整机防锈

可调节到盘：独创回旋切断、进口刀具、寿命长久

单定位式中心导柱，标签导送更加稳定

同步分瓶装置、送瓶更加稳定

标签刷下组，套标精度更高

标签控制电眼架，独创尾翼与电眼结合，提高膜料切断精度

按键式控制箱配合触摸屏操控，操作更人性化

独立供料结构，克自由选择料架位置。

Advanced technology: Schneider servo motor controls synchronous cutting system to ensure long use life of cutting tool and high precision label.

Highly effective production speed: 150bottles/per minute (standard bottle) It can work with the production line or just work alone, labeling speed can be adjusted to 600bottles per minute.

Construction: Stainless steel housing, easy to handle and move with sliding wheels in the bottom.

A unique synchronous cutting base: The cutting base doesn't need changing within the range of specification.

Simple and safe operation: A colored people-controlling operation is used with both English and Chinese versions on it.



参数 PARAMETERS

输入功率Input Power	1.5KW.
输入电压Input Voltage	φ3,380/220VAC.
生产效率Production Efficiency	100-150瓶/分(bottles/min).
主机尺寸Size of Host Machine	2100L×850W×2000H.
适用瓶身直径Applicable Diameter of Bottle	35mm ~ 95mm.
适用标签长度Applicable Length of Label	30mm ~ 250mm.
适用标签厚度Applicable Thickness of Label	0.03mm ~ 0.13mm.
适用纸管内径Applicable Internal Diameter of Paper Tube	5" ~ 10"自由调整 Adjustable
选配 Option	蒸汽收缩炉/电热收缩炉 Steam Tunnel/Electric Tunnel

Positioning Labeling Machine
定位贴标机



特点 FEATURES

专为圆瓶定位标签设计的

采用定位装置，可保证贴标精度，特别适用于360度粘贴的周标。

贴标精度高，细分步进电机或伺服电机驱动送标，送标精准；标带绕行纠偏机构设计，保证标签牵引过程中不左右偏移；偏心轮技术应用于牵引机构，牵引标签不打滑，确保出标精准；

坚固耐用，采用三杆调整机构，充分利用三角形的稳定性，整机结实耐用；

稳定性高，西门子PLC、西门子触摸屏、松下伺服电机组成的高级电控系统，支持设备7×24小时运转；

应用灵活，可单机生产或接流水线生产，生产现场布局简单；

智能控制，自动光电追踪，具备无物不贴标，无标自动校正和标签自动检测功能，防止漏贴和标签浪费；

触摸屏操作界面，全中文注释和完善的故障提示功能，各种参数调整简单快捷，操作方便；

功能强大，具有生产计数功能，省电功能，生产数设定提示功能，参数设置保护功能，方便生产管理

It is special design for the round bottle orientation labeling

With orientation device, the labeling accuracy can be guaranteed, especially suitable for the wrap around label.

PLC Control, Automatically check the length of labels

Equipped with warning device of insufficient labels, broken labels

No bottle, no labeling

No labels, no labeling

Servo motor control, stable labeling

The label head is adjustable for different size of bottles

It fits for different sizes of labels

The height of label height is adjustable to fits different label position on the bottle

The angle of label head is adjustable



参数 PARAMETERS

型号/Item No.	NP-OL
产量/Capacity	30-40瓶/分 BPM (速度可调, 视物件大小及标签长度而定/Depending on bottle sizes and label size)
精度/Accuracy	±1mm
瓶子直径/Bottle Diameter	Φ80-170mm 或定制 Or Customized
瓶高/Bottle Height	高度25mm ~ ~ 300mm (可根据客户要求定做) Or Customized
标签规格/Label Size	高度10mm ~ ~ 150mm 长度 15 ~ ~ 300mm (特殊规格可定做) Or Customized
纸卷内径/Label Roll	I.D. Φ76mm O.D.: Φ320 (Max.)
重量/Weight	200KG
电源/POWER	220V 0.8KW 50/60HZ

其他

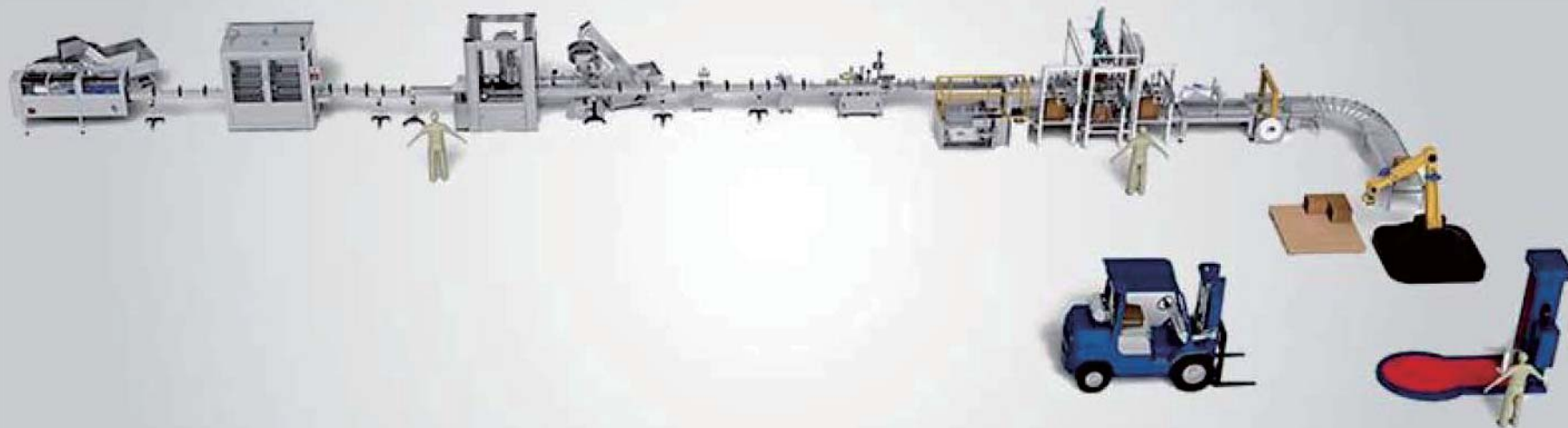

Bottle Feeding&Collecting turntable
理瓶收瓶设备



特点 FEATURES

- 功能先进, 操作简单, 结构紧凑, 全机采用技术成熟 PLC控制系统, 使整机运行稳定、高速
- 操作系统采用触摸屏控制, 操作简便、实用、效率高
- 机身采用不锈钢材质, 保证瓶子清洁无污染
- 进口电器原件, 性能稳定, 故障率极低
- 具有卡瓶停机, 设备异常时报警等功能
- 连线使用时, 拥有输送堵瓶报警功能, 处理后快速启动
- 相对传统理瓶机体积小、速度快, 结构简单, 重量是其一半, 移动运输方便
- 使用范围广, 一机多用且适应性强, 圆瓶、方瓶均能整理, 更换产品不用更换模具配件

1. With advanced functions, simple operation and compact structure, adopts mature PLC control system to make the machine run stably at high speed.
2. The operating system adopts touch screen control, which is simple, practical and efficient.
3. The body is made of stainless steel to ensure the bottle is clean and free of pollution
4. Imported electrical components, stable performance and extremely low failure rate
5. with the alarm function for bottle stuck shutdown and machine abnormal
6. When connected, it has the function of alarming the bottle jam during transportation, and it can restart quickly.
7. With a smaller size, faster speed, simpler structure, lighter weight, and convenient transport, comparing with the traditional bottle unscrambler
8. Wide range of use, multi-purpose and strong adaptability, can apply to round and square bottles, no need to change mold parts when changing bottles

参数 PARAMETERS

No.	Description	NP-LPJ2400
1	Speed	40-70 Depending on Bottles
2	Air Pressure	0.7MPa
3	Air Consumption	0.4M3/min
4	Applied bottles	Samples for confirmation
5	Power	4.5KW
6	Weight	120KG

Carton Sealing
封箱机



参数 Parameters

Carton:	L200-600*W150-500*H120-500mm
Platform Height:	680-800mm
Speed:	18.5M/min
Power:	220V/50HZ
Machine Size:	L1700*W800*H1691mm
Electric Control Part:	OMRON
Pneumatic Parts:	Airtac
Motor:	CPG
Structure:	Steel painted.

Carton Erector
开箱机

参数 Parameters

Model	GPK-40
Production speed	12ctns/min
Carton size(mm)	L250-450xW150-400xH100-400
Power supply	110/220V、50/60HZ、1φ-3φ
Air Compressing	6kg/cm ²
Air consumption	450NL/MIN
Adhesive tape width	48/60/75MM
Machine dimension	L2300xW1900xH1700mm
Machine weight	650KG





特点 FEATURES

- | | |
|---|---|
| 1. 德国IGUS直线导轨 | 1. German IGUS linear guide |
| 2. 德国Leuze电控制系统 | 2. German Leuze photoelectric control system |
| 3. 施耐德PLC及其控制系统 | 3. Schneider PLC and control system |
| 4. Weilun触摸屏控制 | 4. Weilun touch screen control |
| 5. SEW主电机 | 5. SEW main motor |
| 6. AIRTAC气动元件 | 6. AIRTAC pneumatic components |
| 7. 施耐德低压电器 | 7. Schneider low-voltage electrical appliances |
| 8. 施耐德逆变器 | 8. Schneider inverter |
| 9. 所有与瓶子和纸箱接触的零件均采用不锈钢制成；机身采用碳钢焊接，表面涂漆。 | 9. All parts in contact with bottles and cartons are made of stainless steel; the body is welded with carbon steel, and the surface is painted. |
| 10. 有机玻璃防护罩 | 10. Plexiglass protective cover |

参数 Specification

1.	包装形式Packing form	纸箱包装 carton packing
2.	速度Speed	30箱/分 30 cases / minute
3.	装箱层数Packing layers	一层(可定制) one layer (according to customer needs)
4.	尺寸Model size	L 2200*W1880*H3000mm
5.	电源 Equipment power	24V DC
6.	压缩空气 Compressed air	0.4-0.6Mpa, 30L / MIN
7.	重量 Weight	2300Kg

Palletizing Machine
码垛机



ABB Robot 机器人



Operation Range

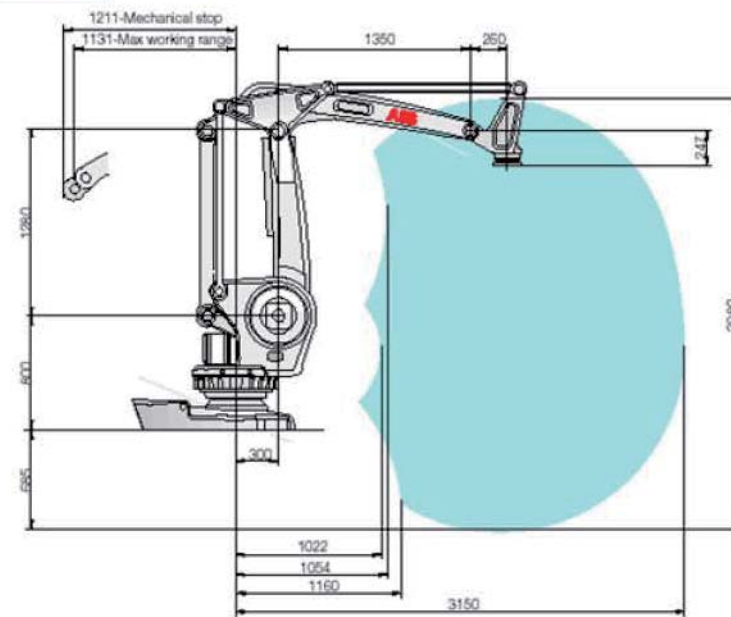

AUTOMATICAL CARTON AND PALLETIZER

自动装箱码垛解决方案

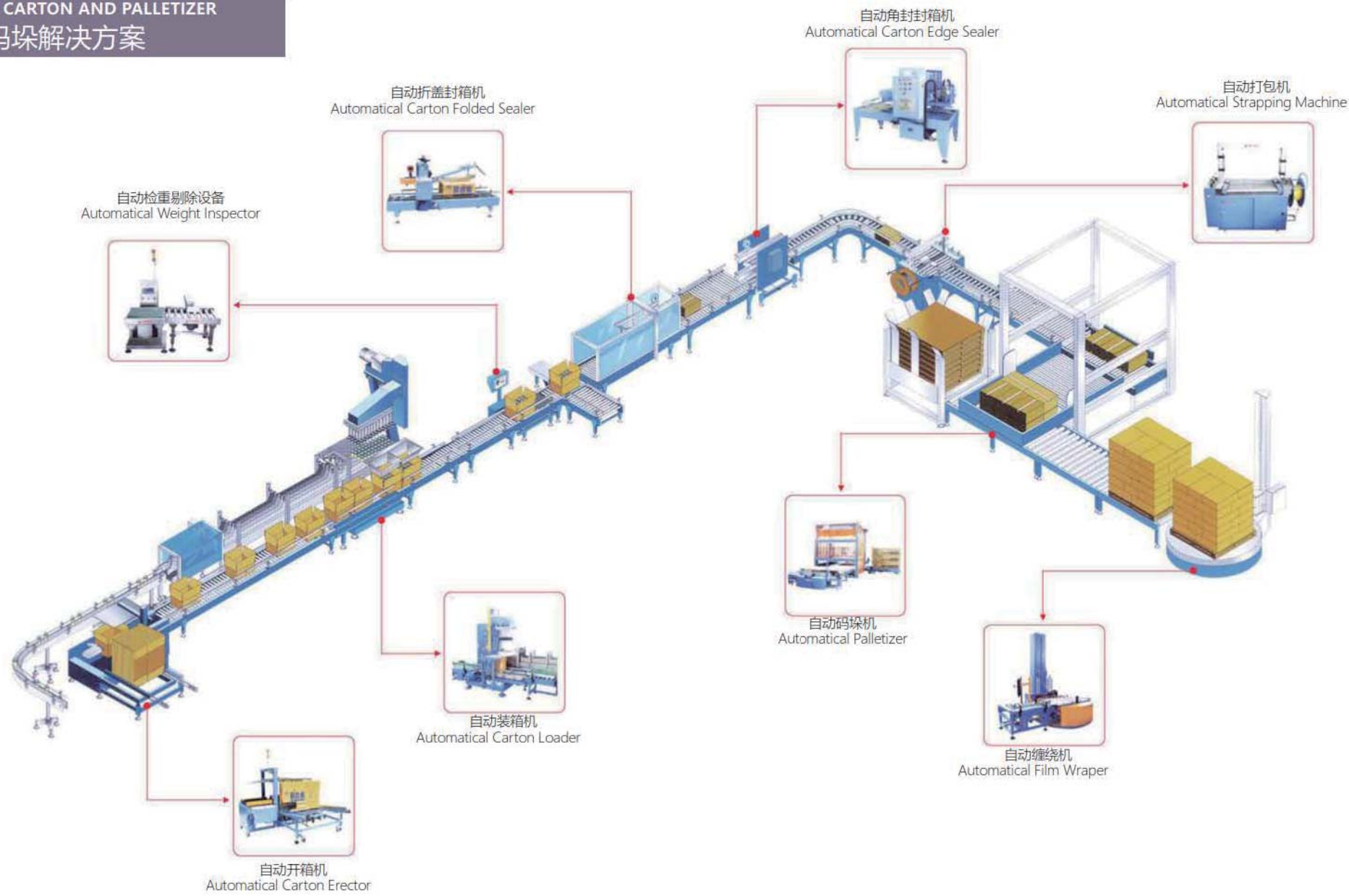

OUR SERVICE 鑫紫鲸服务

如您是为贵司提供高品质且可靠的生产线，我们将为您提供最专业的服务。我们拥有经验丰富的团队，为您提供专业的服务。我们专业的团队将为您提供专业的服务。

鑫紫鲸咨询

如果您有安装流水线的特殊要求，请联系我们，鑫紫鲸的专业团队将为您提供专业的服务。

- 鑫紫鲸咨询团队
- 鑫紫鲸咨询团队

我们提供哪些专业服务

- 鑫紫鲸咨询团队
- 鑫紫鲸咨询团队

项目服务

鑫紫鲸拥有一支专业的团队，我们将为您提供专业的服务。

- 项目服务团队
- 项目服务团队

生产

我们专业的团队为您提供专业的服务。

- 鑫紫鲸生产团队
- 鑫紫鲸生产团队

设备维护与私人定制

我们专业的团队为您提供专业的服务。

- 鑫紫鲸维护团队
- 鑫紫鲸维护团队

鑫紫鲸培训

我们专业的团队为您提供专业的服务。

- 鑫紫鲸培训团队
- 鑫紫鲸培训团队

客户关怀

我们专业的团队为您提供专业的服务。

鑫紫鲸拥有专业的团队，为您提供专业的服务。

我们提供哪些专业服务

鑫紫鲸拥有专业的团队，为您提供专业的服务。

我们提供哪些专业服务

鑫紫鲸拥有专业的团队，为您提供专业的服务。

我们提供哪些专业服务

鑫紫鲸拥有专业的团队，为您提供专业的服务。

我们提供哪些专业服务

鑫紫鲸拥有专业的团队，为您提供专业的服务。

我们提供哪些专业服务

鑫紫鲸拥有专业的团队，为您提供专业的服务。

我们提供哪些专业服务

鑫紫鲸拥有专业的团队，为您提供专业的服务。

我们提供哪些专业服务

鑫紫鲸拥有专业的团队，为您提供专业的服务。

我们提供哪些专业服务

鑫紫鲸拥有专业的团队，为您提供专业的服务。

我们提供哪些专业服务

鑫紫鲸拥有专业的团队，为您提供专业的服务。

鑫紫鲸拥有专业的团队，为您提供专业的服务。

鑫紫鲸拥有专业的团队，为您提供专业的服务。

鑫紫鲸拥有专业的团队，为您提供专业的服务。

我们提供哪些专业服务

鑫紫鲸拥有专业的团队，为您提供专业的服务。

我们提供哪些专业服务

鑫紫鲸拥有专业的团队，为您提供专业的服务。

我们提供哪些专业服务

鑫紫鲸拥有专业的团队，为您提供专业的服务。

我们提供哪些专业服务

鑫紫鲸拥有专业的团队，为您提供专业的服务。

我们提供哪些专业服务

鑫紫鲸拥有专业的团队，为您提供专业的服务。

我们提供哪些专业服务

鑫紫鲸拥有专业的团队，为您提供专业的服务。

我们提供哪些专业服务

鑫紫鲸拥有专业的团队，为您提供专业的服务。

鑫紫鲸拥有专业的团队，为您提供专业的服务。

我们提供哪些专业服务

鑫紫鲸拥有专业的团队，为您提供专业的服务。

我们提供哪些专业服务

鑫紫鲸拥有专业的团队，为您提供专业的服务。

我们提供哪些专业服务

鑫紫鲸拥有专业的团队，为您提供专业的服务。

OUR PARTNER 合作伙伴



OUR MARKETS 现有市场

